

vtech[®]
Baby

User's Manual

Little Friendlies 2-in-1 Activity Centre



© 2013 VTech
Printed in China
91-002856-001 

VTech understands that a child's needs and abilities change as they grow and with that in mind we develop our toys to teach and entertain at just the right level...

vtech Baby

Toys that will stimulate their interest in different textures, sounds and colours

I am...

...responding to colours, sounds and textures

...understanding cause and effect

...learning to touch, reach, grasp, sit-up, crawl and toddle

Birth-36 months

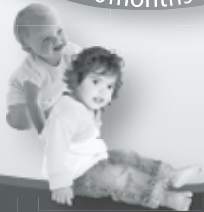

Pre-School

Interactive toys to develop their imagination and encourage language development

I want...

...to get ready for school by starting to learn the alphabet and counting

...my learning to be as fun, easy and exciting as can be

...to show my creativity with drawing and music so my whole brain develops

3-6 years



Electronic Learning Computers

Cool, aspirational and inspiring computers for curriculum related learning

I need...

...challenging activities that can keep pace with my growing mind

...intelligent technology that adapts to my level of learning

...National Curriculum based content to support what I'm learning at school

4-10 years



To learn more about this and other VTech® products, visit www.vtechuk.com

INTRODUCTION

Thank you for purchasing the **VTech® Little Friendlies 2-in-1 Activity Centre** learning toy!

Keep your little one discovering and exploring all day long with the **Little Friendlies 2-in-1 Activity Centre** by **VTech®**! Open and close windows for peek-a-boo animal surprises that develop motor skills. Piano keys and a spinning letter dial play songs and soothing melodies that help encourage first words. Includes straps to attach the activity panel to the back of the cot.

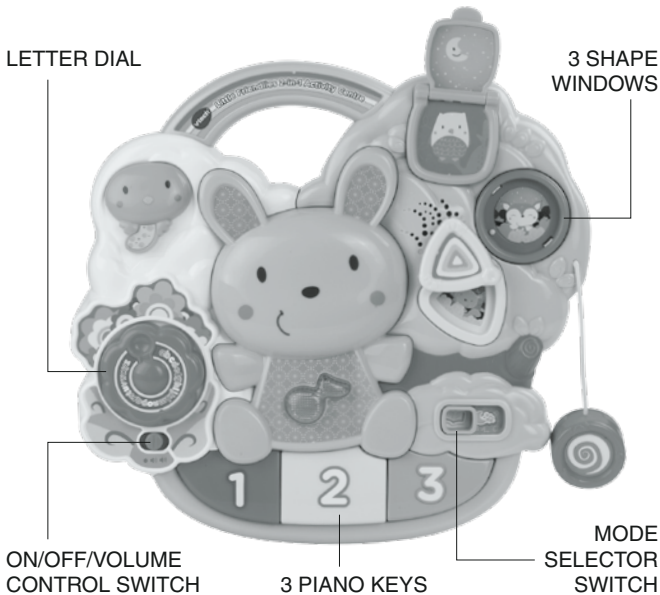

INCLUDED IN THIS PACKAGE

- One VTech® Little Friendlies 2-in-1 Activity Centre
- 2 cot attachment straps
- One instruction manual

WARNING:

All packing materials, such as tape, plastic sheets, packaging locks and tags are not part of this toy, and should be discarded for your child's safety.

NOTE:

Please keep this instruction manual as it contains important information.

Unlock the packing locks:

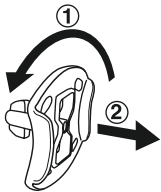

- ① Rotate the packing locks 90 degrees counter-clockwise.
- ② Pull out the packing locks.

GETTING STARTED

BATTERY INSTALLATION

1. Make sure the unit is turned **OFF**.
2. Locate the battery cover on the back of the unit. Use a coin or a screwdriver to loosen the screw.
3. Install 2 new 'AA' (AM-3/LR6) batteries following the diagram inside the battery box. (The use of new alkaline batteries is recommended for maximum performance.)
4. Replace the battery cover and tighten the screw to secure the battery cover.

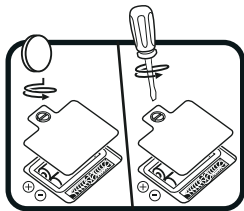

BATTERY NOTICE

- Use new alkaline batteries for maximum performance.
- Use only batteries of the same or equivalent type as recommended.
- Do not mix different types of batteries: alkaline, standard (carbon-zinc) or rechargeable (Ni-Cd, Ni-MH), or new and used batteries.
- Do not use damaged batteries.
- Insert batteries with the correct polarity.
- Do not short-circuit the battery terminals.
- Remove exhausted batteries from the toy.
- Remove batteries during long periods of non-use.
- Do not dispose of batteries in fire.
- Do not charge non-rechargeable batteries.
- Remove rechargeable batteries from the toy before charging (if removable).
- Rechargeable batteries are only to be charged under adult supervision.

Disposal of batteries and product



The crossed-out wheellie bin symbols on products and batteries, or on their respective packaging, indicates they must not be disposed of in domestic waste as they contain substances that can be damaging to the environment and human health.



The chemical symbols Hg, Cd or Pb, where marked, indicate that the battery contains more than the specified value of mercury (Hg), cadmium (Cd) or lead (Pb) set out in Battery Directive (2006/66/EC).

The solid bar indicates that the product was placed on the market after 13th August, 2005.

Help protect the environment by disposing of your product or batteries responsibly.

For more information, please visit:

www.recycle-more.co.uk

www.recyclenow.com

ASSEMBLY INSTRUCTIONS

With the **VTech® Little Friendlies 2-in-1 Activity Centre** safety comes first. To ensure your child's safety, adult assembly is required.

1. Place the unit in the cot. Slide the blue tab to the unlocked () position.

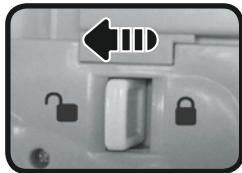

2. Following the arrow on the attachment strap, hook the larger end over the right side of the engraved area above the blue lock/unlock tab.

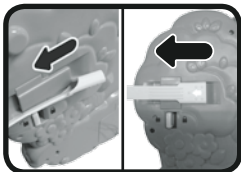

3. Loop the attachment strap around the spindle and thread it into the recessed slot. Feed the strap through the slot and pull it tight around the cot rail.

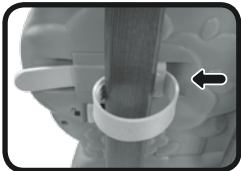

4. Slide the blue tab to the locked (🔒) position.

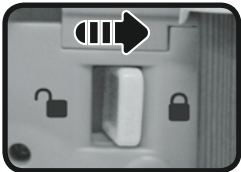

5. Repeat the above steps for the second strap.

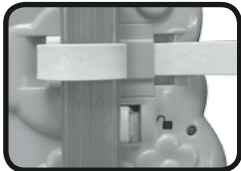



6. Pull slightly on the unit to make sure the straps are securely fastened. The unit should be tight against the cot rails. For extra security, tie the yellow cord to the nearest spindle. Please check the unit regularly to ensure it is still secure.



- The unit can also be used outside of the cot as a floor toy. For your child's safety, please remove the attachment straps and store them in a safe location.

PRODUCT FEATURES

1. ON/OFF/VOLUME CONTROL SWITCH

To turn the unit **ON**, slide the **ON/OFF/VOLUME CONTROL SWITCH** to the low volume () or high volume () position. To turn the unit **OFF**, slide the **ON/OFF/VOLUME CONTROL SWITCH** to the **OFF** () position.

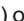

2. MODE SELECTOR SWITCH

Slide the **MODE SELECTOR SWITCH** to the Learning Mode () or Music Mode () position.

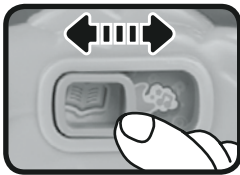

3. AUTOMATIC SHUT-OFF

To preserve battery life, the **VTech® Little Friendlies 2-in-1 Activity Centre** will automatically power-down after approximately 30 seconds without input. The unit can be turned on again by pressing any button.

ACTIVITIES

1. Slide the **ON/OFF/VOLUME CONTROL SWITCH** to turn the unit on. You will hear a song, a playful phrase or a song and a short tune depending on the selected mode. The light will flash with the sound.



2. Press the **piano keys** to learn numbers and colours in the Learning Mode and hear five minutes of music in the Music Mode. The light will flash with the sound.



3. Open or close the **shape windows** to learn shapes, animal names, sing-along songs and fun sounds in the Learning Mode. In the Music Mode you will hear melodies and short tunes. The light will flash with the sound.

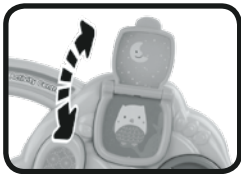

4. Turn the **letter dial** to hear a sing-along song, a fun sound or a random melody depending on the selected mode. The light will flash with the sound.

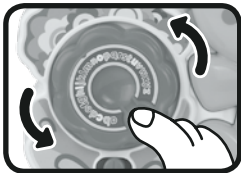

MELODY LIST

1. Sing a Song of Sixpence
2. Here We Go Round the Mulberry Bush
3. Listen to the Mocking Bird
4. Ring Around the Rosy
5. Humpty Dumpty
6. Good Morning Merry Sunshine
7. Teddy Bear's Picnic
8. Ta-Ra-Ra Boom De Ay
9. Pop! Goes the Weasel
10. Where Has My Little Dog Gone?
11. ABC Tumble Down D
12. Oh! Susanna
13. Happy Farmer
14. Hickory Dickory Dock
15. Girls and Boys Come Out to Play
16. Toyland
17. Are You Sleeping?
18. Daisy Bell
19. Diddle Diddle Dumpling
20. Alouette
21. Rock-a-Bye Baby
22. Three Little Kittens
23. Mary Had A Little Lamb
24. Twinkle, Twinkle Little Star
25. Baa Baa Black Sheep

SING-ALONG SONG LIST

Sing-Along Song 1

Hello, hello, it's time to play!
Can you find the animals who are hiding?
Can you slide the animal that's flying?

Sing-Along Song 2

Hush little baby, it's time to rest.
Dreamland is near, quiet time is here.

Sing-Along Song 3

Peek-a-boo little squirrel, peeking out for all to see.

Sing-Along Song 4

Peek-a-boo little fox, I see you hiding in the tree.

Sing-Along Song 5

Peek-a-boo little owl, perched up high in the big green tree.

Sing-Along Song 6

A, B, C, D, E, F, G.
Learn some letters, sing with me!

CARE & MAINTENANCE

1. Keep the unit clean by wiping it with a slightly damp cloth.
2. Keep the unit out of direct sunlight and away from any direct heat source.
3. Remove the batteries when the unit will not be in use for an extended period of time.
4. Do not drop the unit on hard surfaces and do not expose the unit to moisture or water.

TROUBLESHOOTING

If for some reason the program/activity stops working or malfunctions, please follow these steps:

1. Please turn the unit **OFF**.
2. Interrupt the power supply by removing the batteries.
3. Let the unit stand for a few minutes, then replace the batteries.
4. Turn the unit **ON**. The unit should now be ready to play again.
5. If the product still does not work, replace with a new set of batteries.

If the problem persists, please call our Consumer Services Department on 01235 546810 (from UK) or +44 1235 546810 (outside UK) and a service representative will be happy to help you.

IMPORTANT NOTE:

Creating and developing **VTech®** products is accompanied by a responsibility that we take very seriously. We make every effort to ensure the accuracy of the information, which forms the value of our products. However, errors sometimes can occur. It is important for you to know that we stand behind our products and encourage you to call our Consumer Services Department on 01235 546810 (from UK) or +44 1235 546810 (outside UK), with any problems and/or suggestions that you might have. A service representative will be happy to help you.

CLASS 1
LED PRODUCT



PRODUCT WARRANTY



Thank you for choosing this quality product from VTech. We hope it will bring many hours of entertainment, imaginative play and learning.

1. The product detailed above is covered by a one year warranty from the date of purchase, against any defects in materials or workmanship.
2. The product may be returned to the place of purchase. Alternatively the product can be returned to VTech Electronics Europe plc (see address below), with proof of purchase, without proof of purchase no replacement will be provided.
3. VTech Electronics Europe plc will examine the product and if it is found to be defective due to faulty materials or workmanship, will replace the product at their discretion.
4. If the product covered by this warranty is damaged due to misuse, modification or unauthorised repair, or because of faulty batteries, battery discharge or incorrect electrical connections, then this warranty becomes void.
5. This warranty is personal to the original purchaser and is not transferable.
6. Breakages to the LCD screen are not covered by the warranty.
7. Returns to VTech Electronics Europe plc should include a cheque or postal order for £1.50 towards the cost of return postage and packaging.
8. Products returned to VTech Electronics Europe plc, should be addressed as follows and packed carefully to avoid damage in transit (Please do not include batteries or adaptor).
Please include details of the fault together with your name and address.

VTech Electronics Europe plc, c/o Tablogix Limited, 200 Milton Park, Abingdon, Oxon OX14 4TA

THIS WARRANTY IS OFFERED AS AN EXTRA BENEFIT AND DOES NOT AFFECT CONSUMERS' STATUTORY RIGHTS.

This warranty is valid for the UK and Eire only. For products purchased outside the UK and Eire, please contact your local distributor or place of purchase.

